

## Polycom Deskphones

### SoundPoint®

IP 320 <sup>1</sup>	IP 430 <sup>1</sup>	IP 560 <sup>1</sup>
IP 321 <sup>1</sup>	IP 450 <sup>3</sup>	IP 650 <sup>1</sup>
IP 330 <sup>1</sup>	IP 550 <sup>1</sup>	IP 670 <sup>2</sup>
IP 331 <sup>1</sup>		



SoundPoint IP 320 and IP 330 require 2.5mm to RJ-9 converter cable to connect to the headset port (sold separately).

- 1 Requires SIP application 3.1 or higher and BootROM 4.1.0 or later.
- 2 Requires SIP application 3.0.2 or higher and BootROM 4.1.0 or later.
- 3 Requires SIP application 3.1.0 Rev C or higher and BootROM 4.1.0 or later.

Please check [plantronics.com](http://plantronics.com) for more phone options.

## Savi Office

### ORDER INFORMATION



### Savi™ Office

**Designed for seamless communication**  
Next generation of wireless headsets to maximize collaboration through multiple devices. Enterprise grade headset system providing excellent sound quality.

**WO100**  
(Convertible headset system)



### REMOTE CALL ANSWERING

Requires following EHS solution to automatically answer a call by pressing a button on the headset.

APP-50 (sold separately)



### SET UP INFORMATION

For a complete set up list please refer to the user guide.

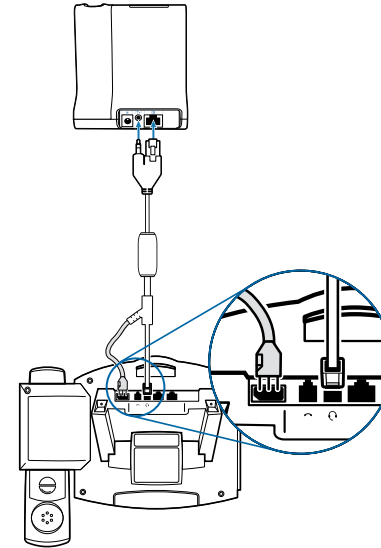

Set desk phone speaking volume to 2

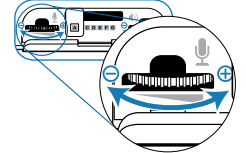

Configuration switch

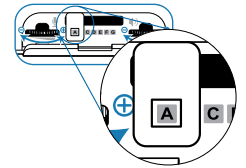

Set desk phone listening volume to 3

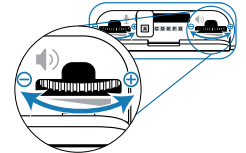

## CS55/CS70N/Plantronics Voyager 510S/SupraPlus Wireless

### ORDER INFORMATION

### Plantronics Voyager® 510S System

**Office and mobile phone usage**  
Use one headset for calls both in and out of the office with a noise cancelling microphone. Share seamlessly between office phone and Bluetooth® mobile phone or smart phone.



Voyager 510S



### CS70N™ Wireless

**Stylish and discreet**  
Combining the excellent sound quality and range of DECT™ with the design edge of a mobile headset.

CS70N



### CS55™ Wireless

**Flexible, cost effective and convenient**  
Cost-effective wireless headset with great range and sound quality and a choice of wearing styles.

CS55



### SupraPlus® Wireless

**All-day wearing comfort**  
For intensive phone users—the ultimate comfort and sound quality—with the option of binaural style for noisy environments.

CS351N Monaural  
CS361N Binaural



### REMOTE CALL ANSWERING

Requires following EHS solution to automatically answer a call by pressing a button on the headset.

APP-5 (sold separately)



### SET UP INFORMATION

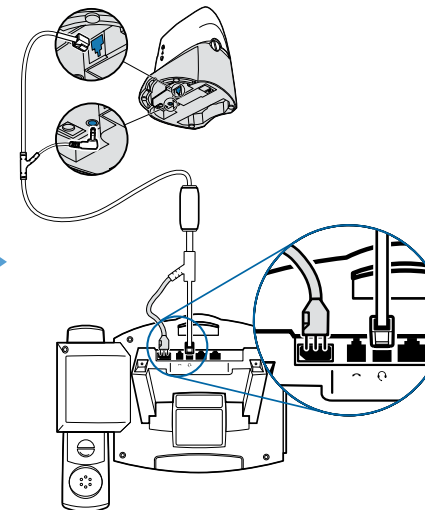

Set rotary switch to 1

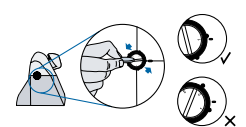

Set rear slide switch to 2

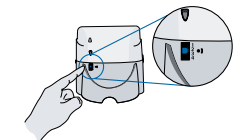

Set bottom slide switch to A

